



POOL FILTRATION

INDEX

- 01** INJECTED SAND FILTERS
“AQUARIUS” TOP VALVE
- 02** INJECTED SAND FILTERS
“AQUARIUS” SIDE VALVE
- 03** FILTRATION SYSTEM “AQUARIUS”
- 04** BOBBIN-WOUND SAND FILTERS
“MUNICH”N
- 05** BLOW-MOLDED FILTERS
“EC3000”
- 06** OCEAN GELCOAT FILTER
- 07** VERTICAL BOBBINED FILTERS
- 08** HORIZONTAL BOBBINED FILTERS
- 09** STAINLESS STEEL SANDFILTERS
TYPE “XE”
TYPE “XR”
- 10** STAINLESS STEEL SANDFILTERS
TYPE “XL”
- 11** HOT ZINC PLATED CARBON
STEEL FILTER TYPE “ZR”
- 12** HOT ZINC PLATED CARBON STEEL
FILTER TYPE “VL”
- 13** CARTRIDGE FILTER “BIG ONE”
- 14** SIX - WAY SELECTOR VALVES
- 15** AUTOMATIC VALVE “AQUASTAR COMFORT”
- 16** CONTROL PANEL FOR VALVE MANIFOLDS
- 17** VALVE MANIFOLDS
- 18** QUARTZ SAND
- 19** ACTIVATED FILTER MEDIA
- 20** ZPM - ZETA POTENTIAL MIXER 30

01 INJECTED SAND FILTERS “AQUARIUS” TOP VALVE

- Sand filter with 6 way selector top valve
- Totally injection molded in polypropylene
- 100% polypropylene, ball-shaped body with micro-hole pipe distribution. Supporting base of the double-ring filter to ensure stability
- Polished and glazed wedges finish
- Draining micro-hole pipe distribution
- Working pressure max. 2.5 bar, Test pressure 4 bar
- Connection filter-valve with clamping collars
- Lateral side connectors $\phi 50$ mm (for 1 1/4" valve)
- 3/4" filter discharge
- Constant re-productivity
- Standard: UNI 1063722006 regulation for TYPE D categories
- Warranty: 5 years

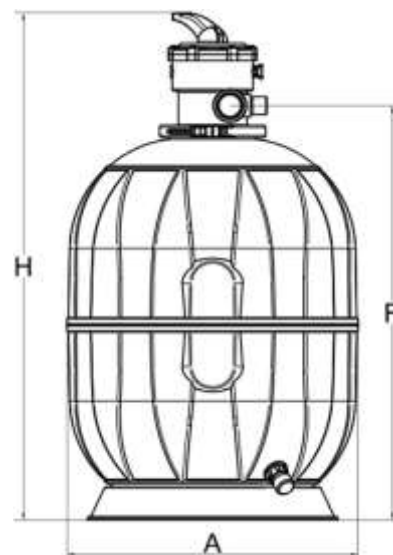

CODE	CONNECTIONS	FLOW	QUARTZ SAND				PACKING	WEIGHT	VOLUME
		(m ³ /h) V=50m ³ /h/ m ²	kg	A	F	H		kg	m ³
100100968	1 1/2"	6	75	450	600	775	2	11	0.13
100100971	1 1/2"	10	100	530	756	925	2	17	0.21
100100974	1 1/2"	14	150	620	792	960	2	20	0.31

02 INJECTED SAND FILTERS “AQUARIUS” SIDE VALVE

- Sand filter with 6 way selector side valve.
- Totally injection molded in polypropylene.
- Polypropylene spherical body; distribution with micro-hole pipe, anti-slip features with nozzles to ease the maintenance operations.
- Automatic air bleed with upper filter base for double-ring filter to guarantee stability lid with pressure gauge seat and manual air bleed.
- Seal is guaranteed by clamps with butterfly valves and nut maintenance does not require tools.
- Polished and glazed wedges finish
- Draining micro-hole pipe distribution
- Working pressure max. 2.5 bar, Test pressure 4 bar.
- Lateral side connectors $\phi 50$ mm (for 1 1/4" valve) and (2563 mm (for 2" valve).
- 3/4" filter discharge
- Standard: UNI 1063722006 regulation for TYPE D categories
- Warranty: 5 years.

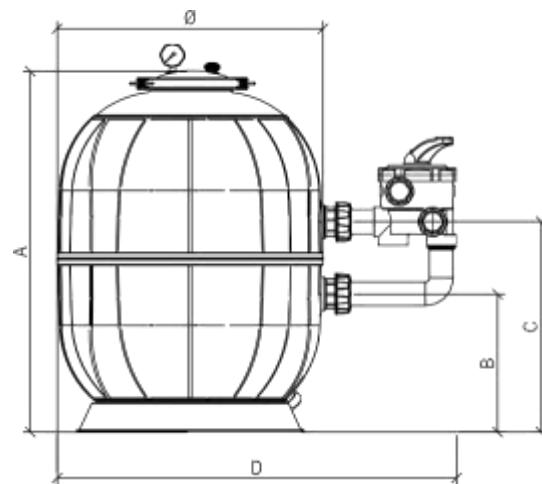

CODE	Ø	CONNECTIONS	FLOW	QUARTZ SAND	DIMENSIONS				PACKING	WEIGHT	VOLUME
			(m ³ /h) V=50m ³ /h/m ²	kg	A	B	C	D		kg	m ³
100100967	450	1 1/2"	6	75	645	206	356	716	2	10	0.13
100100970	530	1 1/2"	10	100	795	281	431	730	2	16	0.21
100100973	620	1 1/2"	14	150	830	299	449	820	2	19	0.09
100100988	790	2"	22	250	1010	360	579	1102	2	29	0.61
100100908	950	2"	35	425	1025	370	570	1270	2	37	0.93

03 FILTRATION SYSTEM "AQUARIUS"

- An exclusive and unique design built with state of the art technology, fully injected 100% food grade Polypropylene guaranteeing maximum reliability and performance. The "Aquarius" range sand filters have been designed and manufactured using only first grade raw materials.
- 100% polypropylene, ball-shaped body with micro-hole pipe distribution. Supporting base of the double-ring filter to ensure stability.
- Polished and glazed wedges finish
- Filtration system with a 6 way top selector valve assembled on a base with pump and prefilter. For pump check Lipari pump
- Draining micro—hole pipe distribution
- Max. working pressure: 2.5 bar, Test pressure 4 bar.
- Connection filter—valve with clamping collars.
- 3/4" filter discharge
- Standard: UNI 10637:2006 regulation for TYPED categories
- Warranty: 5 years on filter

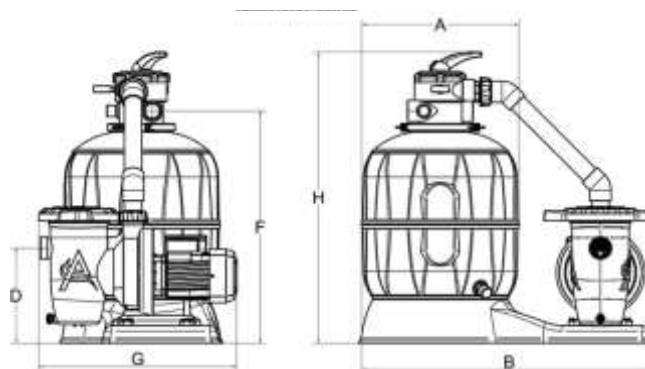

CODE	TYPE	POWER		IN-OUT	FLOW (m³/h) V=50m³/h/ m²	QUARTZ SAND kg	FILTRATION AREA m²	DIMENSIONS						PACKING	WEIGHT kg	VOLUME m³
		HP	KW					A	H	B	D	F	G			
100100977	Top	0.50	0.37	DN50	6	75	0.12	450	835	830	275	665	570	1	20	0.32
100100978	Top	0.75	0.55	DN50	10	100	0.20	530	985	870	275	815	570	1	25	0.46
100100979	Top	1	0.75	DN50	14	150	0.28	620	1020	915	275	855	570	1	30	0.57

04 BOBBIN-WOUND SAND FILTERS “MUNICH”N

- Bobbin-wound fiber glass reinforced tank with UV-resistant surface finish
- Max operating pressure 2.5 bar, Test pressure 4 bar
- Fitted with pressure gauge, manual air and water purges
- Fitted with collector arms & diffuser made in UPVC
- Top mount filter comes with closure & screw
- Side mount filter 450, 550, 600, 700, comes with glass top cover seal clamps with butterfly valve 7 nuts
- Side mount filter 800 & 900 comes with top cover made of (Abs and mix poly carbonate) & Side screw closure
- Side mount filter 1000 & 1200 comes with top cover & center clamp closure
- Fitters are equipped with a six -position multiport valve
- Warranty: 5 years



CODE	DIMENSIONS						
	A	B	C	D	E	F	G
MU-450N-VT	814	698	638	210	450	390	-
MU-550N-VT	845	730	670	235	550	500	-
MU-650N-VT	950	835	775	300	650	500	-
MU-700N-VT	1020	905	845	330	700	500	-
MU-450N-VS	360	420	730	210	450	390	125
MU-550N-VS	390	450	770	235	550	500	125
MU-650N-VS	430	390	850	235	650	500	125
MU-700N-VS	450	510	960	330	700	500	125
MU-800N-VS	560	646	1050	425	800	780	220
MU-900N-VS	610	696	1180	480	900	780	220
MU-1000N-VS	700	770	1220	580	1000	780	220
MU-1200N-VS	820	1005	1410	740	1200	1000	220

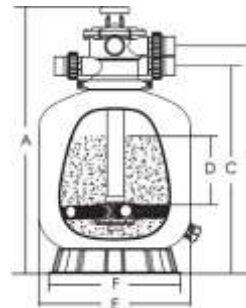

MU-450N-VT / 550 / 650 / 700

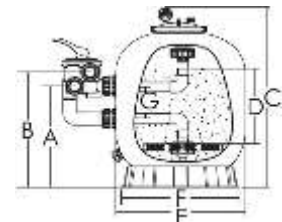

MU-450N-VS / 550 / 650 / 700

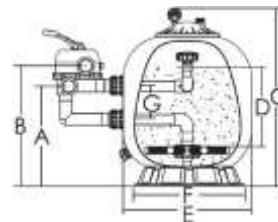

MU-800N-VS/900

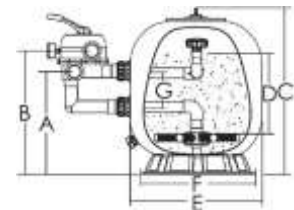

MU-1000N-VS/1200

CODE	TYPE	Ø	CONNECTIONS	FLOW	QUARTZ SAND	FILTER AREA	PACKING	WEIGHT	VOLUME
				(m ³ /h) V=50m ³ /h/m ²	kg	m ²		kg	m ³
MU-450N-VT	Top	450	1.5"	8	75	0.16	2	16.5	0.19
MU-550N-VT	Top	550	1.5"	10	125	0.22	2	21.1	0.23
MU-650N-VT	Top	650	1.5"	16	150	0.30	2	24.3	0.38
MU-700N-VT	Side	700	1.5"	19	225	0.40	2	26.5	0.34
MU-450N-VS	Side	450	1.5"	8	75	0.16	2	16.5	0.19
MU-550N-VS	Side	550	1.5"	10	125	0.22	2	21.1	0.23
MU-650N-VS	Side	650	1.5"	16	150	0.30	2	24.3	0.38
MU-700N-VS	Side	700	1.5"	19	225	0.50	2	33	0.45
MU-800N-VS	Side	800	2"	25	300	0.50	2	41.5	0.67
MU-900N-VS	Side	900	2"	30	400	0.64	2	52.3	0.95
MU-1000N-VS	Side	1000	2.5"	40	650	0.98	2	115	1.84
MU-1200N-VS	Side	1200	3"	56	1000	1.13	2	124	2.32

05 BLOW-MOLDED FILTERS “EC3000”

- One piece blow-molded filters made in PE-HD with side or top mounted multiport valves.
- Including pressure gauge, manual air vent and water purge.
- Maximum working pressure 2.5 bar, Test pressure 4 bar.
- Very durable and rigid structure.
- Warranty: 5 years.

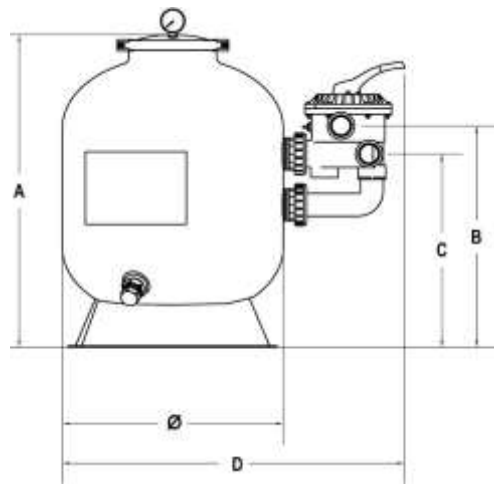
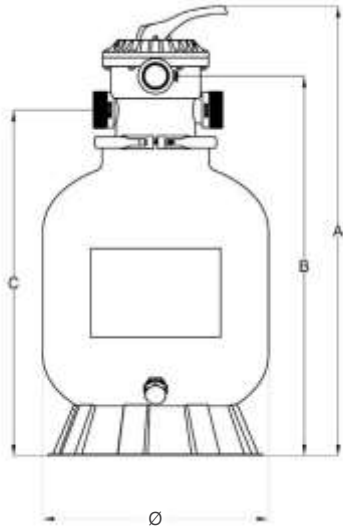

CODE	TYPE	Ø	FLOW	QUARTZ SAND	DIMENSIONS				PACKING	WEIGHT	VOLUME
			(m ³ /h) V=50m ³ /h/m ²	kg	A	B	C	D		kg	m ³
FRL-400	Side	400	6	50	580	430	355	676	2	8.00	0.12
FRL-500	Side	500	9	75	680	490	430	755	2	10.50	0.22
FRL-600	Side	600	14	100	880	630	560	880	2	14.00	0.37
FTS-400	Top	400	6	50	810	685	624	676	2	8.00	0.12
FTS-500	Top	500	9	75	913	788	727	755	2	10.50	0.22
FTS-600	Top	600	14	100	1108	982	921	880	2	14.00	0.37

06 OCEAN GELCOAT FILTER

- Non corrosive Gelcoat fiber glass tank with smooth finishing
- Max operating pressure 2.5 bar, Test pressure 4 bar
- Universal standard of union connection is provided
- ABS lateral system
- Pressure gauge is provided
- OC-SIDE: Equipped with 6-way clamp/bolt style multiport valve
- OC-TOP: Transparent lid provides clear view of filter media, and air release valve allows accumulated air getting out of the tank
- 6 Way multiport valve is included
- Warranty: 5 years

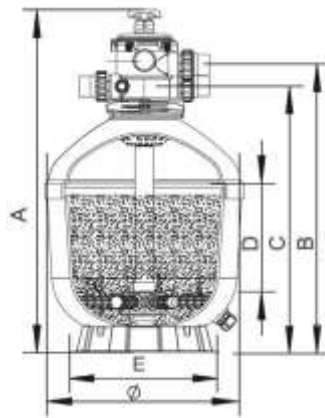

TOP - T
OC-500-S / OC-650-S
OC-750-S / OC-900-S

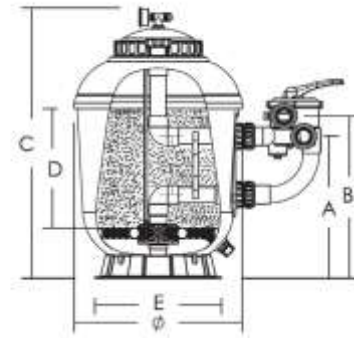

SIDE - S
OC-500-T / OC-650-T

CODE	Ø	TYPE	CONNECTIONS	FLOW	QUARTZ SAND	DIMENSIONS					PACKING	WEIGHT	VOLUME
				(m ³ /h) V=50m ³ /h/m ²	kg	A	B	C	D	E		kg	m ³
OC-500-T	500	Top	1.5"	10	100	886	750	693	286	390	2	16.6	0.25
OC-650-T	650	Top	1.5"	16	150	998	862	805	318	500	2	28	0.45
OC-500-S	500	Side	1.5"	10	100	438	501	835	360	390	2	18.3	0.21
OC-650-S	650	Side	1.5"	16	150	453	516	926	380	390	2	24.5	0.38
OC-750-S	750	Side	2"	22	250	517	603	1023	440	500	2	38	0.55
OC-900-S	900	Side	2"	30	375	570	656	1163	480	780	2	57.8	0.90

07 VERTICAL BOBBINED FILTERS

- Bobbin wound fiber glass reinforcement with polyester resin
- Multi-construction layers: non-corrosive and chemical protective
- UV resistance, suitable for operation under prolong sunlight
- Available in laterals or nozzles plate system for air scouring capabilities
- Optional accessories includes sight glass, manhole, and air purge
- Design filtration velocity maximum: 50m³/h/m²
- Max operating pressure 2.5 / 4 bar, test pressure 4/6 bar
- Manifold & valves not included
- Warranty: 5 years



Nozzles System



Lateral System



Air Purge



Manhhole



Sight Glass

MODEL	Ø	QUARTZ SAND	DIMENSIONS					
		kg	A	B	C	D	E	G
FB-1200	1200	1200	190	630	550	1180	1816	995
FB-1400	1400	1800	200	630	550	1180	1816	1220
FB-1600	1600	3000	220	720	490	1210	1916	1365
FB-1800	1800	3800	220	750	440	1190	1956	1630
FB-2000	2000	5100	230	770	490	1260	2060	1630
FB-2200	2200	7600	230	940	500	1440	2376	1800
FB-2500	2500	8500	230	1050	550	1500	2670	1800
FBH-1200	1200	2800	170	665	350	1015	2080	995
FBH-1400	1400	2700	190	675	350	1025	2175	1220
FBH-1600	1600	3600	200	775	350	1125	2310	1365
FBH-1800	1800	4100	220	780	415	1195	2320	1630
FBH-2000	2000	5400	220	865	415	1280	2460	1630
FBH-2300	2300	9200	230	1060	550	1610	2720	1800
FBH-2500	2500	10400	230	1120	550	1670	2750	1800

FB-1200 TO FB-2500

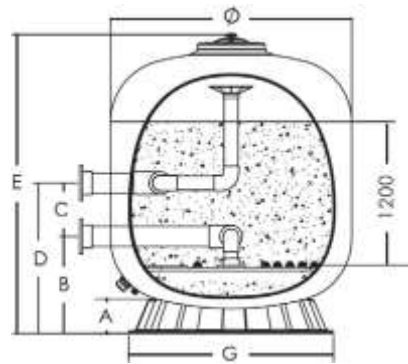

FBH-1200 TO FBH-2500

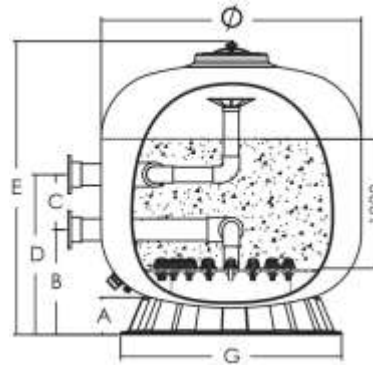

Working pressure: 2.5kg/cm²
 Test pressure: 4 kg/cm²

CODE		CONNECTIONS	FILTER AREA	FLOW	PACKING	WEIGHT	VOLUME
		mm	M ²	(m ³ /h) V=50m ³ /h/m ²		kg	m ³
FB-1200-2.5-LAT	FB-1200-4-LAT	90	1.13	55	1	139	2.26
FB-1400-2.5-LAT	FB-1400-4-LAT	110	1.54	77	1	225	3.25
FB-1600-2.5-LAT	FB-1600-4-LAT	125	2.01	102	1	273.5	4.76
FB-1800-2.5-LAT	FB-1800-4-LAT	140	2.54	125	1	412	6.67
FB-2000-2.5-LAT	FB-2000-4-LAT	160	3.14	147	1	450	9.03
FB-2200-2.5-LAT	FB-2200-4-LAT	200	3.8	190	1	554	15.02
FB-2500-2.5-LAT	FB-2500-4-LAT	225	4.90	240	1	680	21.68
FB-1200-2.5-NOZ	FB-1200-4-NOZ	90	1.13	55	1	139	2.26
FB-1400-2.5-NOZ	FB-1400-4-NOZ	110	1.54	77	1	225	3.25
FB-1600-2.5-NOZ	FB-1600-4-NOZ	125	2.01	102	1	273.5	4.76
FB-1800-2.5-NOZ	FB-1800-4-NOZ	140	2.54	125	1	412	6.67
FB-2000-2.5-NOZ	FB-2000-4-NOZ	160	3.14	147	1	450	9.03
FB-2200-2.5-NOZ	FB-2200-4-NOZ	200	3.8	190	1	554	15.02
FB-2500-2.5-NOZ	FB-2500-4-NOZ	225	4.90	240	1	680	21.68
FBH-1200-2.5-LAT	FBH-1200-4-LAT	90	1.13	45	1	238	3.35
FBH-1400-2.5-LAT	FBH-1400-4-LAT	110	1.54	61	1	258	4.58
FBH-1600-2.5-LAT	FBH-1600-4-LAT	125	2.06	80	1	473	6.20
FBH-1800-2.5-LAT	FBH-1800-4-LAT	140	2.52	101	1	473	7.94
FBH-2000-2.5-LAT	FBH-2000-4-LAT	160	2.97	125	1	772	10.38
FBH-2300-2.5-LAT	FBH-2300-4-LAT	200	4.43	175	1	658.5	1621
FBH-2500-2.5-LAT	FBH-2500-4-LAT	225	4.89	200	1	760	17.88
FBH-1200-2.5-NOZ	FBH-1200-4-NOZ	90	1.13	45	1	238	3.35
FBH-1400-2.5-NOZ	FBH-1400-4-NOZ	110	1.54	61	1	258	4.58
FBH-1600-2.5-NOZ	FBH-1600-4-NOZ	125	2.06	80	1	473	6.20
FBH-1800-2.5-NOZ	FBH-1800-4-NOZ	140	2.52	101	1	473	7.94
FBH-2000-2.5-NOZ	FBH-2000-4-NOZ	160	2.97	125	1	772	10.38
FBH-2300-2.5-NOZ	FBH-2300-4-NOZ	200	4.43	175	1	658.5	1621
FBH-2500-2.5-NOZ	FBH-2500-4-NOZ	225	4.89	200	1	760	17.88

08 HORIZONTAL BOBBINED FILTERS

- Bobbin wound fiber glass reinforcement with polyester resin
- Multi-construction layers: non-corrosive and chemical protective
- UV resistance, suitable for operation under prolong sunlight
- Inner filtration system with evenly spread laterals enhance filtration performance.
- Service manhole for easy maintenance
- Equipped with manometer for easy inspection of the working pressure of both inlet and outlet.
- Design filtration velocity: 20/30/40 m³/h/m²
- Max operating pressure 2.5 / 4 bar
- Suggested size of media 0.5-0.8mm, 1-2mm
- Manifolds & valves not include
- Warranty: 5 years

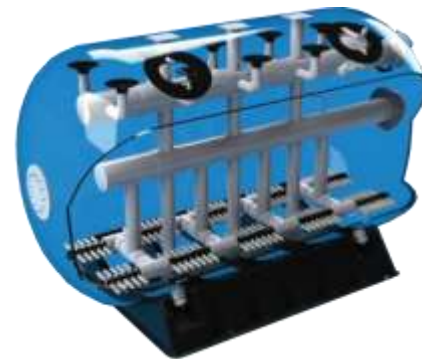

FILTRATION VELOCITY	LENGTH	DIAMETER															
		1200		1400		1600		1800		2000		2350		2500		3000	
m ³ /h/m ²	mm	Conn.	Flow	Conn.	Flow	Conn.	Flow	Conn.	Flow	Conn.	Flow	Conn.	Flow	Conn.	Flow	Conn.	Flow
20	1900	110	39	110	45	110	49										
	2300	110	48														
	2500	110	53	110	60												
	2700	110	57														
	3000	110	64	110	73							140	119				
	3500									140	125	140	141	140	149	225	180
	4000							140	125	140	144	225	163	225	172	225	208
	4500											225	186	225	196	225	236
	5000											225	208	225	220	225	265
30	2500					150	101	150	112	150	130						
	2700																
	3000			140	110	140	123	140	137	140	159	225	178				
	3500							140	162	140	187	225	212	225	223	250	270
	4000							140	187	140	216					250	312
	4500								187	140	245			250	294	250	355
	5000											250	312	250	329	250	397
40	1900	140	79	140	89	140	99										
	2300	140	97														
	2500	140	53	140	121	225	134	225	174	225	174						
	2700	140	57														
	3000	140	64	225	147	225	164	225	212	225	212	250	238				
	3500							250	250	225	250	250	282	250	297	300	360
	4000							250	288	225	288	250	327	250	345	300	416
	4500							250	326	225	326	250	371	300	392	300	473
	5000											300	416	300	439	300	530

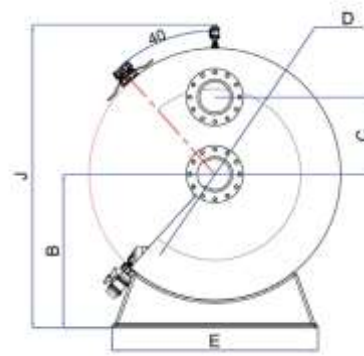
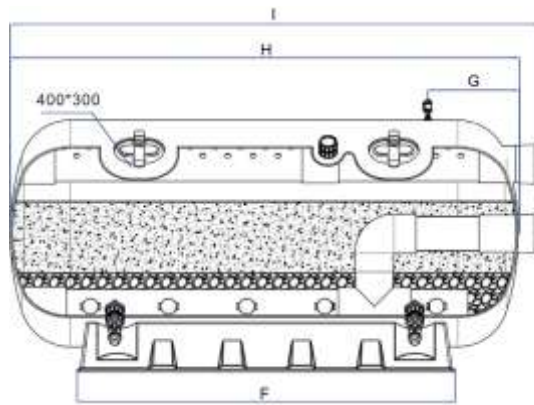

Sight glass



Lateral system



Manhole



Manometer



Base



Union drain



Air vent valve



Flange

Ø	CODE		FILTRA-TION VELOCITY	FILTRA-TION AREA	DIMENSIONS									QUARTZ SAND	PACK-ING	WEIGHT	VOLUME
	2.5 BAR	4 BAR	m ³ /h/m ²	M ²	B	C	D	E	F	G	H	I	J	kg		kg	m ³
1200	H-4472-2.5	H-4472-4	20	1.96	747	325	1200	1100	1190	650	1900	2030	1500	1525	1	361	4.52
	H-4473-2.5	H-4473-4	40	1.96	747	325	1200	1100	1190	650	1900	2060	1500	1525	1	435	4.33
	H-4474-2.5	H-4474-4	20	2.42	747	325	1200	1100	1590	650	2300	2430	1500	1975	1	415	4.98
	H-4475-2.5	H-4475-4	40	2.42	747	325	1200	1100	1590	650	2300	2460	1500	1975	1	510	5.14
	H-4476-2.5	H-4476-4	20	2.65	747	325	1200	1100	1790	650	2500	2630	1500	2450	1	435	5.39
	H-4477-2.5	H-4477-4	40	2.65	747	325	1200	1100	1790	650	2500	2660	1500	2450	1	435	5.54
	H-4478-2.5	H-4478-4	20	2.87	747	325	1200	1100	1990	650	2700	2830	1500	2900	1	470	6.47
	H-4479-2.5	H-4479-4	40	2.87	747	325	1200	1100	1990	650	2700	2860	1500	2900	1	565	5.95
	H-4480-2.5	H-4480-4	20	3.21	747	325	1200	1100	2290	650	3000	3130	1500	3250	1	510	8.21
1400	H-4481-2.5	H-4481-4	40	3.21	747	325	1200	1100	2290	650	3000	3160	1500	3250	1	625	6.56
	H-4482-2.5	H-4482-4	20	2.23	847	390	1400	1130	1340	730	1900	2030	1700	2675	1	450	5.47
	H-4483-2.5	H-4483-4	40	2.23	847	390	1400	1130	1340	730	1900	2060	1700	2675	1	550	5.69
	H-4484-2.5	H-4484-4	20	3.02	847	390	1400	1130	1840	730	2500	2630	1700	3625	1	550	8.36
	H-4485-2.5	H-4485-4	40	3.02	847	390	1400	1130	1840	730	2500	2660	1700	3625	1	615	7.39
	H-4486-2.5	H-4486-4	20	3.67	847	390	1400	1130	2340	730	3000	3130	1700	4450	1	550	10.12
	H-4487-2.5	H-4487-4	30	3.67	847	390	1400	1130	2340	730	3000	3160	1700	4450	1	575	8.93
	H-4488-2.5	H-4488-4	40	3.67	847	390	1400	1130	2340	730	3000	3180	1700	4450	1	710	9.01

POOL FILTRATION

Ø	CODE		FILTRATION VELOCITY	FILTRATION AREA	DIMENSIONS								QUARTZ SAND	PACK-ING	WEIGHT	VOLUME	
	2.5 BAR	4 BAR	m³/h/m²	M²	B	C	D	E	F	G	H	I	J		kg	kg	m³
1600	H-4489-2.5	H-4489-4	20	2.47	945	475	1600	1440	1210	810	1900	2130	1900	3450	1	490	7.84
	H-4490-2.5	H-4490-4	40	2.47	945	475	1600	1440	1210	810	1900	2160	1900	3450	1	615	7.94
	H-4491-2.5	H-4491-4	30	3.36	945	475	1600	1440	1710	810	2500	2660	1900	4725	1	575	9.66
	H-4492-2.5	H-4492-4	40	3.36	945	475	1600	1440	1710	810	2500	2680	1900	4725	1	715	9.73
	H-4493-2.5	H-4493-4	30	4.10	945	475	1600	1440	2210	810	3000	3160	1900	5800	1	670	13.32
	H-4494-2.5	H-4494-4	40	4.10	945	475	1600	1440	2210	810	3000	3180	1900	5800	1	825	11.59
1800	H-4495-2.5	H-4495-4	30	3.74	1100	550	1800	1380	1560	850	2500	2660	2170	5825	1	650	12.26
	H-4496-2.5	H-4496-4	40	3.74	1100	550	1800	1380	1560	850	2500	2680	2170	5825	1	860	12.53
	H-4497-2.5	H-4497-4	30	4.58	1100	550	1800	1380	2060	850	3000	3160	2170	7150	1	790	15.22
	H-4498-2.5	H-4498-4	40	4.58	1100	550	1800	1380	2060	850	3000	3180	2170	7150	1	980	15.31
	H-4499-2.5	H-4499-4	30	5.41	1100	550	1800	1380	2060	850	3500	3680	2170	8475	1	890	17.46
	H-4500-2.5	H-4500-4	40	5.41	1100	550	1800	1380	2560	850	3500	3680	2170	8475	1	1100	17.54
	H-4501-2.5	H-4501-4	20	6.25	1100	550	1800	1380	3060	850	4000	4160	2170	9775	1	990	18.98
	H-4502-2.5	H-4502-4	30	6.25	1100	550	1800	1380	3060	850	4000	4180	2170	9775	1	1220	19.25
	H-4503-2.5	H-4503-4	40	6.25	1100	550	1800	1380	3060	850	4000	4180	2170	9775	1	1280	19.25
2000	H-4504-2.5	H-4504-4	30	4.34	1200	710	2000	1720	1380	1000	2500	2660	2370	7626	1	800	12.02
	H-4505-2.5	H-4505-4	40	4.34	1200	710	2000	1720	1380	1000	2500	2680	2370	7626	1	1000	11.22
	H-4506-2.5	H-4506-4	30	5.30	1200	710	2000	1720	1880	1000	3000	3160	2370	9325	1	895	15.85
	H-4507-2.5	H-4507-4	40	5.30	1200	710	2000	1720	1880	1000	3000	3180	2370	9325	1	1125	16.21
	H-4508-2.5	H-4508-4	20	6.25	1200	710	2000	1720	2380	1000	3500	3660	2370	11025	1	1000	20.01
	H-4509-2.5	H-4509-4	30	6.25	1200	710	2000	1720	2380	1000	3500	3680	2370	11025	1	1250	18.76
	H-4510-2.5	H-4510-4	40	6.25	1200	710	2000	1720	2380	1000	3500	3680	2370	11025	1	1280	18.76
	H-4511-2.5	H-4511-4	20	7.21	1200	710	2000	1720	2880	1000	4000	4160	2370	12725	1	1090	23.70
	H-4512-2.5	H-4512-4	30	7.21	1200	710	2000	1720	2880	1000	4000	4180	2370	12725	1	1345	22.14
	H-4513-2.5	H-4513-4	40	7.21	1200	710	2000	1720	2880	1000	4000	4180	2370	12725	1	1430	22.14
	H-4514-2.5	H-4514-4	30	8.16	1200	710	2000	1720	3380	1000	4500	4680	2370	14450	1	1170	26.86
	H-4515-2.5	H-4515-4	40	8.16	1200	710	2000	1720	3380	1000	4500	4680	2370	14450	1	1460	24.99

Ø	CODE		FILTRATION VELOCITY	FILTRATION AREA	DIMENSIONS										QUARTZ SAND	PACK-ING	WEIGHT	VOUME
	2.5 BAR	4 BAR	m³/h/m²	M²	B	C	D	E	F	G	H	I	J	kg	kg		m³	
2350	H-4516-2.5	H-4516-4	20	5.94	1390	710	2350	1950	1270	1180	3000	3160	2730	11875	1	1030	22.35	
	H-4517-2.5	H-4517-4	30	5.94	1390	710	2350	1950	1270	1180	3000	3180	2730	11875	1	1320	23.00	
	H-4518-2.5	H-4518-4	40	5.94	1390	710	2350	1950	1270	1180	3000	3180	2730	11875	1	1340	23.00	
	H-4519-2.5	H-4519-4	20	7.06	1390	710	2350	1950	1170	1180	3500	3660	2730	14175	1	1125	27.33	
	H-4520-2.5	H-4520-4	30	7.06	1390	710	2350	1950	1170	1180	3500	3680	2730	14175	1	1425	26.46	
	H-4521-2.5	H-4521-4	40	7.06	1390	710	2350	1950	1170	1180	3500	3680	2730	14175	1	1480	26.46	
	H-4522-2.5	H-4522-4	20	8.17	1390	710	2350	1950	2270	1180	4000	4180	2730	16450	1	1270	31.20	
	H-4523-2.5	H-4523-4	40	8.17	1390	710	2350	1950	2270	1180	4000	4180	2730	16450	1	1595	30.05	
	H-4524-2.5	H-4524-4	20	9.28	1390	710	2350	1950	2770	1180	4500	4680	2730	18725	1	1450	33.37	
	H-4525-2.5	H-4525-4	40	9.28	1390	710	2350	1950	2770	1180	4500	4680	2730	18725	1	1805	33.37	
	H-4526-2.5	H-4526-4	20	10.4	1390	710	2350	1950	3270	1180	5000	5180	2730	21000	1	1595	36.61	
	H-4527-2.5	H-4527-4	30	10.4	1390	710	2350	1950	3270	1180	5000	5180	2730	21000	1	1975	36.61	
H-4528-2.5	H-4528-4	40	10.4	1390	710	2350	1950	3270	1180	5000	5180	2730	21000	1	2000	36.61		
2500	H-4529-2.5	H-4529-4	20	7.34	1480	710	2500	2120	1850	1270	3500	3660	2900	14850	1	1170	28.42	
	H-4530-2.5	H-4530-4	30	7.34	1480	710	2500	2120	1850	1270	3500	3680	2900	14850	1	1500	28.80	
	H-4531-2.5	H-4531-4	40	7.34	1480	710	2500	2120	1850	1270	3500	3680	2900	14850	1	1520	28.80	
	H-4532-2.5	H-4532-4	20	8.62	1480	710	2500	2120	2350	1270	4000	4180	2900	17225	1	1320	32.60	
	H-4533-2.5	H-4533-4	40	8.62	1480	710	2500	2120	2350	1270	4000	4180	2900	17225	1	1680	32.60	
	H-4534-2.5	H-4534-4	20	9.80	1480	710	2500	2120	2850	1270	4500	4680	2900	19650	1	1480	21.50	
	H-4535-2.5	H-4535-4	30	9.80	1480	710	2500	2120	2850	1270	4500	4680	2900	19650	1	1860	21.50	
	H-4536-2.5	H-4536-4	40	9.80	1480	710	2500	2120	2850	1270	4500	4680	2900	19650	1	1960	21.50	
	H-4537-2.5	H-4537-4	20	10.98	1480	710	2500	2120	3350	1270	5000	5180	2900	22050	1	1650	40.50	
	H-4538-2.5	H-4538-4	30	10.98	1480	710	2500	2120	3350	1270	5000	5180	2900	22050	1	2170	40.50	
	H-4539-2.5	H-4539-4	40	10.98	1480	710	2500	2120	3350	1270	5000	5180	2900	22050	1	2190	40.50	
3000	H-4540-2.5	H-4540-4	20	8.98	1730	710	3000	2600	1880	1480	3500	3680	3410	22375	1	1460	41.47	
	H-4541-2.5	H-4541-4	30	8.98	1730	710	3000	2600	1880	1480	3500	3680	3410	22375	1	1860	41.47	
	H-4542-2.5	H-4542-4	40	8.98	1730	710	3000	2600	1880	1480	3500	3680	3410	22375	1	1890	41.47	
	H-4543-2.5	H-4543-4	20	10.40	1730	710	3000	2600	2380	1480	4000	4180	3410	25975	1	1650	46.56	
	H-4544-2.5	H-4544-4	30	10.40	1730	710	3000	2600	2380	1480	4000	4180	3410	25975	1	2075	46.56	
	H-4545-2.5	H-4545-4	40	10.40	1730	710	3000	2600	2380	1480	4000	4180	3410	25975	1	2090	46.56	
	H-4546-2.5	H-4546-4	20	11.82	1730	710	3000	2600	2880	1480	4500	4680	3410	29600	1	1835	52.52	
	H-4547-2.5	H-4547-4	30	11.82	1730	710	3000	2600	2880	1480	4500	4680	3410	29600	1	2300	52.52	
	H-4548-2.5	H-4548-4	40	11.82	1730	710	3000	2600	2880	1480	4500	4680	3410	29600	1	2330	52.52	
	H-4549-2.5	H-4549-4	20	13.24	1730	710	3000	2600	3380	1480	5000	5180	3410	33175	1	2030	57.72	
	H-4550-2.5	H-4550-4	30	13.24	1730	710	3000	2600	3380	1480	5000	5180	3410	33175	1	2440	57.72	
	H-4551-2.5	H-4551-4	40	13.24	1730	710	3000	2600	3380	1480	5000	5180	3410	33175	1	2450	57.72	

09 STAINLESS STEEL SAND FILTER TYPE "XE"

- Manufactured with AISI 304 V2A or AISI 316 L V4A
- Internal water distribution. (Nozzle plate on demand add -lux to the code)
- Hand hole \varnothing 280/400.
- External has shiny finish.
- Maximum working pressure: 2.5 bar
- Test pressure: 4 bar
- Warranty: 5 years
- On demand filter can be supplied:
 - working pressure 4 bar - test pressure 6 bar (add -0406 to the code)
 - working pressure 6 bar - test pressure 10 bar (add -0610 to the code)
 - working pressure 10 bar - test pressure 15 bar (add -1015 to the code)
 - Supplied with 6 way multiport valve for filters up to 950mm

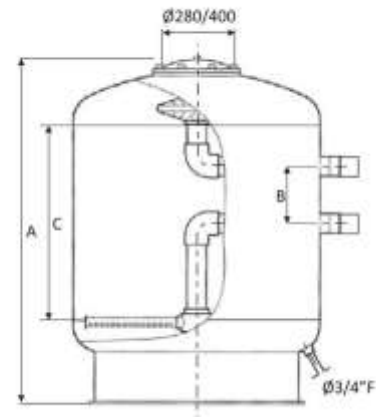

CODE		\varnothing	CONNECTIONS	FLOW	QUARTZ SAND	DIMENSIONS			PACKING	WEIGHT	VOLUME
				(m ³ /h) V=50m ³ /h/m ²	kg	A	B	C		kg	m ³
XE-500	XE-500-316	500	1½"	10	200	1050	200	750	2	54	0.28
XE-630	XE-630-316	630	1½"	15	300	1130	200	750	2	70	0.47
XE-800	XE-800-316	800	2"	25	450	1200	200	750	2	90	0.79
XE-950	XE-950-316	950	2"	35	700	1300	200	750	1	112	1.2
XE-1100	XE-1100-316	1100	2½"	47	900	1350	200	750	1	112	1.2
XE-1200	XE-1200-316	1200	3"	56	1200	1400	200	750	1	160	2.4

10 STAINLESS STEEL SAND FILTER TYPE "XR" BED HEIGHT 1250MM

- Manufactured with AISI 304 V2A or AISI 316 L V4A
- Internal water distribution: Nozzle plate
- External pikling.
- Magnesium anode protection.
- Maximum working pressure: 2.5 bar
- Test pressure: 4 bar
- Warranty: 5 years
- On demand filter can be supplied:
 - working pressure 4 bar - test pressure 6 bar (add -0406 to the code)
 - working pressure 6 bar - test pressure 10 bar (add -0610 to the code)
 - working pressure 10 bar - test pressure 15 bar (add -1015 to the code)

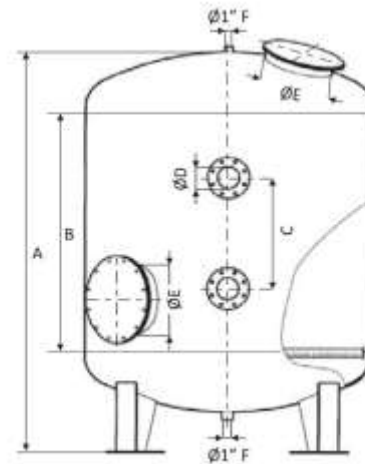

CODE		Ø	CONNECTIONS	FLOW	QUARTZ SAND	DIMENSIONS					PACKING	WEIGHT kg	VOLUME m ³
				(m ³ /h) V=50m ³ /h/m ²	kg	A	B	C	D	E			
XR-1250	XR-1250-316	1250	DN 80	60	2000	2040	1250	400	Ø80	Ø280/400	1	900	4.9
XR-1400	XR-1400-316	1400	DN 100	77	2700	2160	1250	500	Ø100	Ø400	1	1000	5.5
XR-1600	XR-1600-316	1600	DN 100	100	3100	2340	1250	500	Ø100	Ø400	1	1100	8.5
XR-1800	XR-1800-316	1800	DN 125	127	4000	2400	1250	500	Ø125	Ø400	1	1350	10.3
XR-2000	XR-2000-316	2000	DN 150	157	4900	2400	1250	500	Ø150	Ø400	1	1550	11.5
XR-2200	XR-2200-316	2200	DN 200	190	5700	2400	1250	500	Ø200	Ø400	1	1750	12.6
XR-2400	XR-2400-316	2400	DN 200	226	6786	2450	1250	500	Ø200	Ø400	1	2050	14.4

11 STAINLESS STEEL SAND FILTER TYPE "XL" BED HEIGHT 1500MM

- Manufactured with AISI 304 V2A or AISI 316 L V4A
- Internal water distribution nozzle plate.
- From 500 to 2400 External pikling.
- Magnesium anode protection.
- Maximum working pressure: 2.5 bar
- Test pressure: 4 bar
- Warranty: 5 years
- On demand filter can be supplied:
 - working pressure 4 bar - test pressure 6 bar (add -0406 to the code)
 - working pressure 6 bar - test pressure 10 bar (add -0610 to the code)
 - working pressure 10 bar - test pressure 15 bar (add -1015 to the code)
- Supplied with multiport 6 way valve for filters up to 950mm

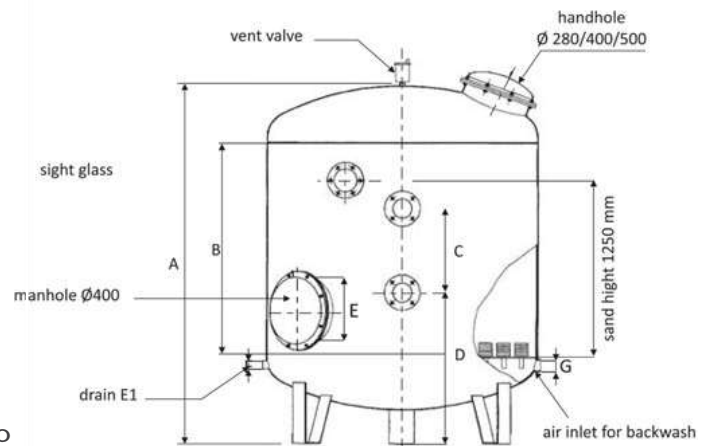

CODE	Ø	CONNECTIONS	FLOW (m ³ /h) V=50m ³ /h/m ²	DIMENSIONS								QUARTZ SAND kg	PACKING	WEIGHT kg	VOLUME m ³
				A	B	C	D	E	F	G					
XL-500	XL-500-316	500	1.5"	10	1950	1500	400	900	Ø400	1"	1½"	375	2	150	1.9
XL-630	XL-630-316	630	1.5"	15	1950	1500	400	900	Ø400	1"	1½"	575	2	220	2.3
XL-800	XL-800-316	800	2"	25	2050	1500	400	900	Ø400	1"	1½"	900	2	380	3.3
XL-950	XL-950-316	950	2"	35	2100	1500	500	900	Ø400	1"	1½"	1300	2	540	4
XL-1100	XL-1100-316	1100	DN 65	47	2150	1500	500	900	Ø400	1"	2"	1925	1	810	5.2
XL-1250	XL-1250-316	1250	DN 80	60	2200	1500	500	900	Ø400	1"	2"	2300	1	930	6
XL-1400	XL-1400-316	1400	DN 100	77	2300	1500	600	900	Ø400	1"	2"	3300	1	1050	7.4
XL-1600	XL-1600-316	1600	DN 125	100	2400	1500	600	900	Ø400	1"	2"	3925	1	1150	9.2
XL-1800	XL-1800-316	1800	DN 125	125	2540	1500	600	1000	Ø400	1½"	2½"	4700	1	1450	11.6
XL-2000	XL-2000-316	2000	DN 150	157	2650	1500	600	1000	Ø400	1½"	2½"	5600	1	1650	14
XL-2200	XL-2200-316	2200	DN 150	189	2700	1500	600	1000	Ø400	1½"	3"	7100	1	1950	16
XL-2400	XL-2400-316	2400	DN 200	225	2750	1500	600	1000	Ø400	1½"	3"	8400	1	2250	18.1

12 HOT ZINC PLATED CARBON STEEL FILTER TYPE “ZR”

- Carbon steel filters varnished with epossidic paints
- h. Body bandage 1250 mm
- Complete with: manhole and handhole; internal water distribution: with arm collectors
- Filtration rate: 50 m³/h x m¹;H
- Sand: 1000/1100 mm
- Internal water distribution with nozzle plate: + 20%
- Max. working pressure 2.5 bar
- Test pressure 4bar
- Warranty: 5 years

PLEASE NOTE:

- You are recommended to earth the installation.
- Nozzle plate on demand (add -lux to the code)

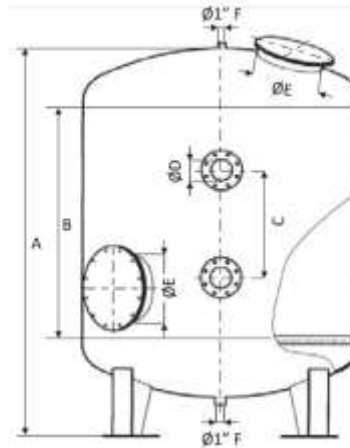

CODE	Ø	CONNECTIONS	FLOW	QUARTZ SAND	DIMENSIONS					PACKING	WEIGHT	VOLUME
			(m ³ /h) V=50m ³ /h/m ²	kg	A	B	C	D	E		kg	m ³
01001	1250	Din 80	60	2000	2040	1250	900	Ø90	Ø400	1	1040	4.9
01002	1500	Din 100	88	2900	2160	1250	900	Ø90	Ø400	1	1125	5.5
01006	1600	Din 125	100	2900	2160	1250	900	Ø140	Ø400	1	1200	8.5
01003	1800	Din 125	127	2900	2160	1250	900	Ø140	Ø400	1	1450	10.3
01004	2000	Din 150	190	5700	2400	1250	900	Ø160	Ø400	1	1650	11.5
01007	2200	Din 150	196	5700	2400	1250	900	Ø160	Ø400	1	1850	12.6
01005	2400	Din 200	226	6786	2450	1250	900	Ø225	Ø400	1	2150	14.4

13 HOT ZINC PLATED CARBON STEEL FILTER TYPE “VL” BED HEIGHT 1500

- Carbon steel filters varnished with epossidic paints
- h. Body bandage 1250 mm
- Complete with: manhole and handhole
internal water distribution: with arm collectors
- Filtration rate: 30 m³/h x m²;H
- Sand:1250/1300 mm
- With nozzleplate
- Max. working pressure 2.5 bar
- Test pressure 4bar
- Warranty: 5years
- Valve notincluded

PLEASE NOTE:
You are recommended to earth the installation.

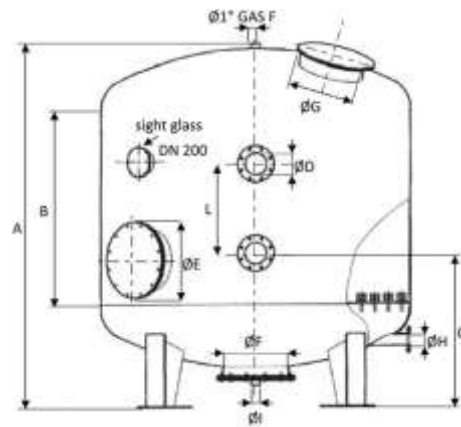

CODE	Ø	CONNECTIONS	FLOW (m ³ /h) V=50m ³ /h/m ²	QUARTZ SAND kg	DIMENSIONS								PACKING	WEIGHT kg	VOLUME m ³	
					A	B	C	L	ØD	ØE	ØF	ØH				ØI
01011	1250	DN 80	60	2300	2300	1500	1000	600	90	400	400	DN 65	1" F	1	1070	6
01013	1400	DN 100	70	3300	2400	1500	1000	600	110	400	500	DN 65	1" F	1	1150	7.4
01014	1600	DN 125	100	3920	2400	1500	1100	600	140	400	500	DN 65	1½" F	1	1250	9.2
01015	1800	DN 125	117	4700	2600	1500	1100	600	140	500	500	DN 65	1½" F	1	1550	11.6
01017	2000	DN 150	130	5600	2600	1500	1100	600	160	500	500	DN 65	2" F	1	1750	14
01019	2200	DN 150	196	7100	2650	1500	1100	600	160	500	500	DN 65	2" F	1	2050	16
01020	2400	DN 200	220	8400	2700	1500	1100	600	160	500	600	DN 65	2" F	1	2350	18.1
01022	2800	DN 200	300	11500	3100	1500	1100	600	225	500	600	DN 65	2" F	1	2550	20
01023	3000	DN 200	350	13000	3150	1500	1100	600	225	500	600	DN 100	2" F	1	2750	22.1

14 CARTRIDGE FILTER “BIG ONE”

- Big One is a unique polypropylene housing for professional applications where high performances and reliable products are needed.
- Designed to treat high quantity of water, it's a two-pieces compact container, that can fit 23" and 40" filtering elements.
- The housing is made with 3" female In-Out threading without brass inserts, and it's equipped with, plastic drain plug and plastic relief valve.
- Big One is provided with a stainless steel clamp that enable to open and close (easily and quickly) the housing during maintenance operatic"
- Max. working pressure: 6 bar.
- Burst pressure: 20 bar.
- Max. working temperature: 40" C.
- Capacity (empty) at 2 bar: 60m3/h.
- Filtration grade: 40 micron
- 5 years warranty

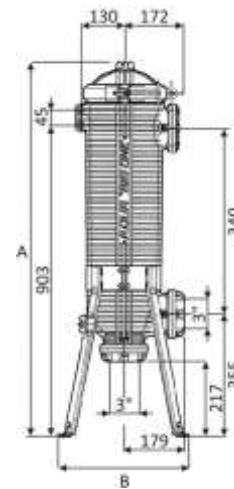

CODE	HIGHT	CONNEX-TIONS	DIMENSIONS		PACKING	WEIGHT kg	VOLUME m³
			A	B			
A1150110	23"	3"	1090	388	1	19	0.02
A1150120	40"	3"	1500	388	1	22.5	0.28

- Made of polyester, core in PP, end caps in FON and O-ring in NBR.
- The polyester filtration cartridge is available in 2 sizes 23" and 40".
- Inner diameter 76 mm, external diameter 147.5 mm.
- Efficiency: 95%
- Max. working pressure: 6 bar.
- Max. differential pressure suggested: 0.8 bar
- Max. working temperature: 80° C.

CODE	HIGHT	FILTRATION GRADE	FLOW	PACKING	WEIGHT kg	VOLUME m³
		micron	(m³/h)			
A4088010	23"	3	14	1	1.3	0.02
A4088020	23"	20	22	1	1.3	0.02
A4088030	23"	50	27	1	1.3	0.02
A4088040	40"	3	28	1	2.2	0.03
A4088050	40"	20	44	1	2.2	0.03
A4088060	40"	50	54	1	2.2	0.03



15 SIX-WAY SELECTOR VALVES



- 6-way selector valve for filtering, washing, rinsing, recirculating, emptying and closing operations.
- Made of premium, UV resistant, impact resisting ABS material.
- Manufactured with extremely long-lasting sealing materials & pressure springs, which are mounted at the valveplate

CODE	DIMENSIONS												
	A	B	C	D	E	F	G	H	I	K	L	M	X
SV-15	99	180	31.5	48.5	60	165	247	41.5	87.5	175	135.5		30
SV-20	110	227	36	60	81	210	296	36	115	230	135.5		36
SV-25	364	298	50	278	50	50	97	298	56.5	60	56.50	42	
SV-30	364	298	50	278	50	50	97	298	56.5	60	56.50	42	
TV-15 AQUARIS	130	-	31.5	38	59.5	235.5	245	41.5	90	180	135.5	46	30
TV-15 MUNICH	145	84	332	196	185	62	245						
TV-15 EC- 3000	232.5	117.4	359.7	61	111								
TV-15 OCEAN	148	360	185	38	38	38	38						

CODE	MOUNTING	CONNECTIONS	PRESSURE	PACKING	WEIGHT	VOLUME
			bar		kg	m ³
SV-15	Side	1½"	3.5	1	1.5	0.01
SV-20	Side	2"	3.5	1	2	0.02
SV-25	Side	2.5"	3.5	1	2.5	0.02
SV-30	Side	3"	3.5	1	3	0.03
TV-15 AQUARIS	Top	1½"	3.5	1	1.5	0.01
TV-15 MUNICH	Top	1½"	3.5	1	1.5	0.01
TV-15 EC- 300	Top	1½"	3.5	1	1.5	0.01
TV-15 OCEAN	Top	1½"	3.5	1	1.5	0.01

SIX-WAY VALVES
IMAGES & DRAWINGS



SV-15/SV-20

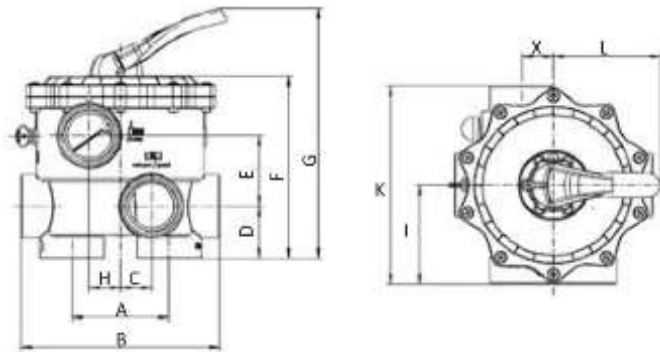

SV-25

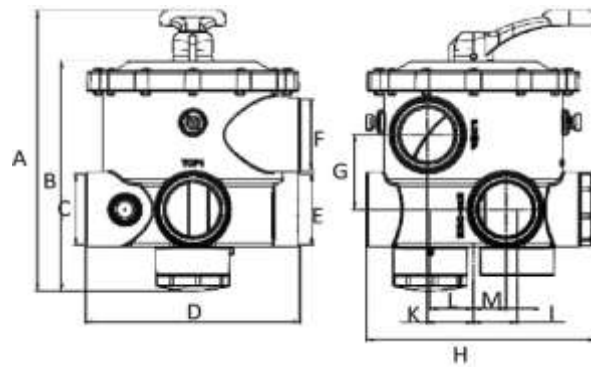

SV-30

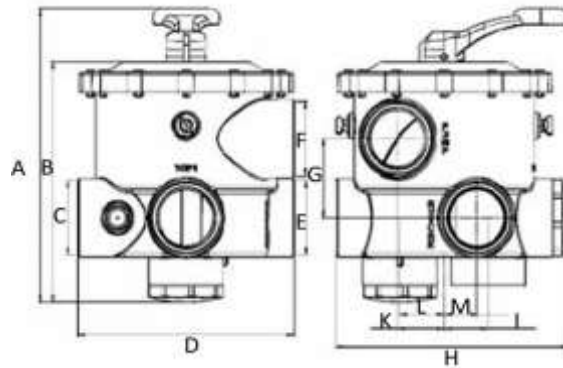

TV-15 AQUARIS

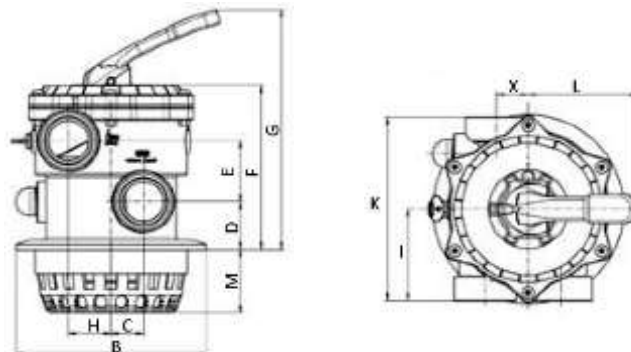

POOL FILTRATION



TV-15 EC-300

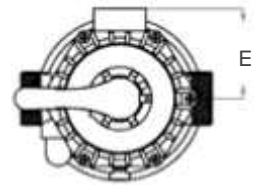
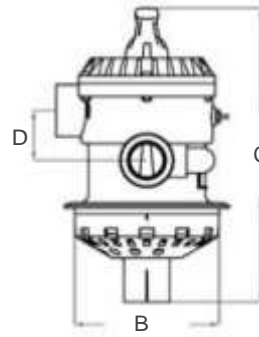
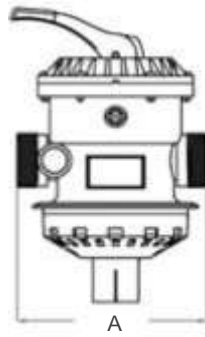

TV-MUNICH

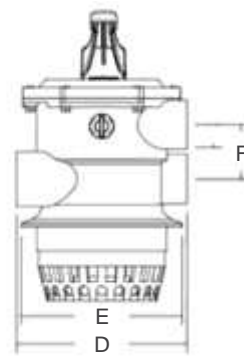
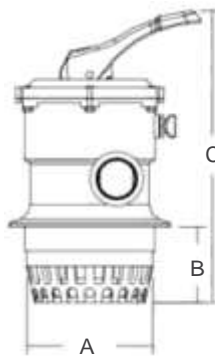

TV-15OCEAN

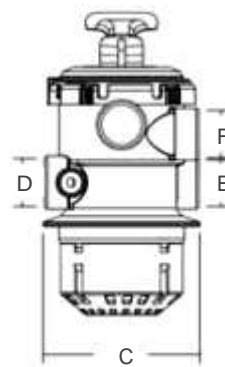
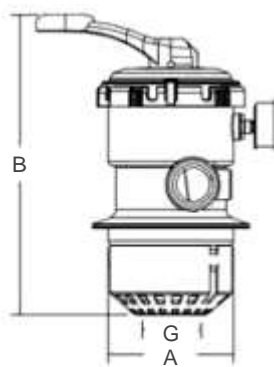

16 AUTOMATIC VALVE "AQUASTAR COMFORT"

- Developed for exclusive private and public swimming pools and aquaparks which are not equipped with a separate PLC control but should be run by fully automatic
- Characterized by its solid construction and variety adjusted to the individual needs.
- Moreover this series has the same advantages as the AQUASTAR EASY and many more:
 - Available for AQUA 6 way valves 1" comes with side mount and top mount
 - 5 positions can be controlled by your own PLC control system (filter/back wash/rinse/ drain/ circulation)
 - Optic position display on actuator lid.
 - Manual override for all dimensions, potential free connections for E0510 ball valve or additional pump (possibly: 2nd pump)
 - MVO 12-34 VAC; 12-230 VAC.
 - IP 65 protection rate

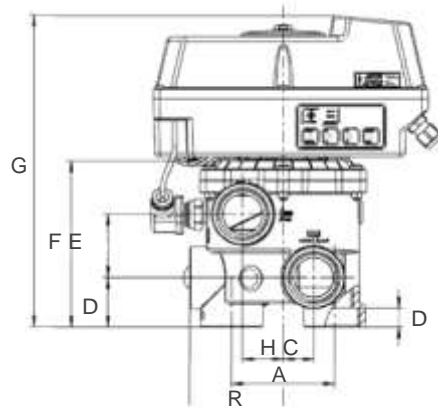
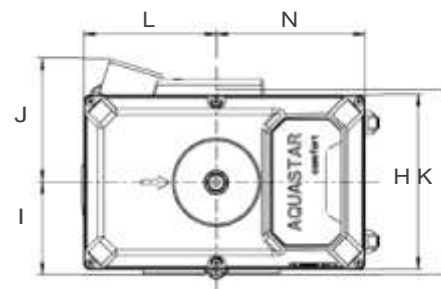

Side Mount (SM)

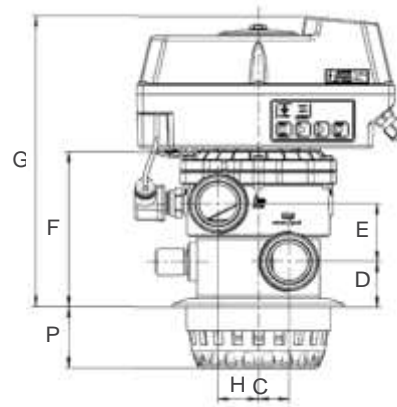

Top Mount (TM)

POOL FILTRATION

Setting of back wash process with timer

	BACK WASH TIME (S1)	RINSE TIME (S2)	BACK WASH FREQUENCY (S3)
	45 seconds	20 seconds	off
	75 seconds	40 seconds	after 3 days
	2 minutes	1 minutes	after 7 days
	6 minutes	1½ minutes	after 14 days

Regulation by pressure (0.5-3.5 bar)

	0:0.5 bar	4:0.9 bar	8:1.3 bar	C:2.0 bar
	1:0.6 bar	5:1.0 bar	9:1.4 bar	D:2.5 bar
	2:0.7 bar	6:1.1 bar	A:1.5 bar	E:3.0 bar
	3:0.8 bar	7:1.2 bar	B:1.75 bar	F:3.5 bar

	DIMENSIONS														
	A	B	C	D	E	F	G	H	I	J	K	L	M	N	O
1.5" TM	99.5	90	29.5	48	61.5	163.5	295	39	87.5	117	175	125	165	140	18.5
1.5" SM	-	-	31.5	47	59.5	160	291	41.5	90	117	228	125	165	140	26
2" SM	110	114	38	60	81	210	339	36	114	117	228	125	165	140	26

CODE	DESCRIPTION	PACKING	WEIGHT	VOLUME
			kg	m³
SAB-015-TM	Automatic Valve 1½" Top Mount with Time + Pressure Switch	1	4	0.03
SAB-015-SM	Automatic Valve 1½" Side Mount with Time + Pressure Switch	1	4	0.03
SAB-020-SM	Automatic Valve 2" Side Mount with Time + Pressure Switch	1	5	0.04

17 CONTROL PANEL FOR VALVE MANIFOLDS

- Control panel for electrically or pneumatically actuated manifolds of 5 valves.
- For automatic filtration, backwashing, rinsing and shut-down operations.
- Fitted with automatic programming installation that enables the execution of all required operations and can be personalised to suit your requirements.
- Quick and easy installation with numbered terminal connection strip.
- Voltage 230V single phase.
- Time and pressure control.

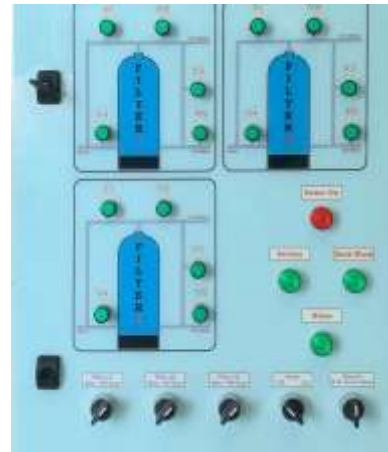

CODE	DESCRIPTION	PACKING	WEIGHT	VOLUME
			kg	m ³
CPA5V-E-1	Control panel for electrically actuated manifolds of 5 valves for 1 filter	1		
CPA5V-E-2	Control panel for electrically actuated manifolds of 5 valves for 2 filters	1		
CPA5V-E-3	Control panel for electrically actuated manifolds of 5 valves for 3 filters	1		
CPA5V-E-4	Control panel for electrically actuated manifolds of 5 valves for 4 filters	1		
CPA5V-E-5	Control panel for electrically actuated manifolds of 5 valves for 5 filters	1		
CPA5V-E-6	Control panel for electrically actuated manifolds of 5 valves for 6 filters	1		
CPA5V-P-1	Control panel for pneumatically actuated manifolds of 5 valves for 1 filter	1		
CPA5V-P-2	Control panel for pneumatically actuated manifolds of 5 valves for 2 filters	1		
CPA5V-P-3	Control panel for pneumatically actuated manifolds of 5 valves for 3 filters	1		
CPA5V-P-4	Control panel for pneumatically actuated manifolds of 5 valves for 4 filters	1		
CPA5V-P-5	Control panel for pneumatically actuated manifolds of 5 valves for 5 filters	1		
CPA5V-P-6	Control panel for pneumatically actuated manifolds of 5 valves for 6 filters	1		

18 VALVE MANIFOLDS



- All valve manifolds (manual or Electric & pneumatic) DN 75 TO 160 with flanges for connections to filters DN 6 for 200 to 300
- The Implex range of valves characterized by the multi-standard design of screw housing, making it suitable for any market. It made of PVC which it very versatile. As it can be adapted to a great deal of applications. It can be started through a clutch or a trigger.
- Inside the pipes according to the standard UNE-EN-1452 (PVC-U) and UNE - EN 12201 (PE)
- The Implex model allows to fit flanges with different standards: DN 8063, ANS| 16.5, BS 10 tabala D/E, UNE-EN 1452 (PVC-U)
- One set consist of 5 Valves, 6 Flange sets, 2 Elbows & 5 Tees
- All manifolds are supplied disassembled and without support brackets.

CODE	Ø	MANIFOLD TYPE	NO. OF VALVES	PACKAGING	WEIGHT kg	VOLUME m³
MM5-075	75	Manual	5	1	11.1	0.02
MM5-090	90				16.48	0.03
MM5-110	110				18.56	0.03
MM5-125	125				20.96	0.04
MM5-140	140				23.60	0.05
MM5-160	160				30.24	0.05
MM5-200	200				44.96	0.07
MM5-225	225				44.96	0.07
MM5-250	250				79.84	0.20
MM5-300	300				176	0.17
AM5-075	75	Electric	5	1	15.52	0.08
AM5-090	90				19.2	0.08
AM5-110	110				19.2	0.10
AM5-125	125				24	0.16
AM5-140	140				41.6	0.20
AM5-160	160				41.6	0.24
AM5-200	200				41.6	0.34
AM5-225	225				41.6	0.34
AM5-250	250				41.6	0.43
AM5-300	300				41.6	0.54
PM5-075	75	Pneumatic	5	1	34	0.08
PM5-090	90				41	0.08
PM5-110	110				67	0.14
PM5-125	125				70	0.16
PM5-140	140				101	0.23
PM5-160	160				110	0.27
PM5-200	200				140	0.46
PM5-225	225				140	0.46
PM5-250	250				275	0.54
PM5-300	300				252	0.82



MANUAL VALVE



ELECTRIC DRIVEN VALVE



PNEUMATIC DRIVEN VALVE

LOAD LOSS CURVES

VALVES 75MM

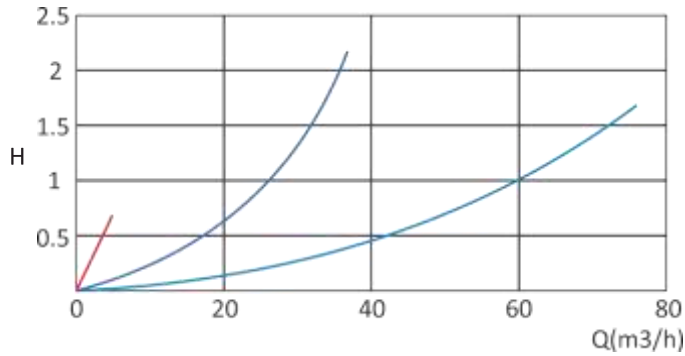

VALVES 90MM

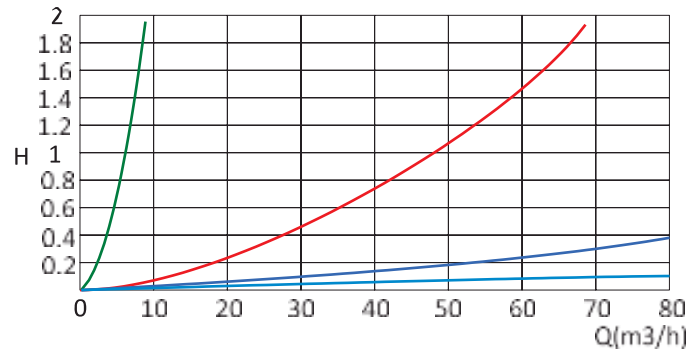

VALVES 110MM

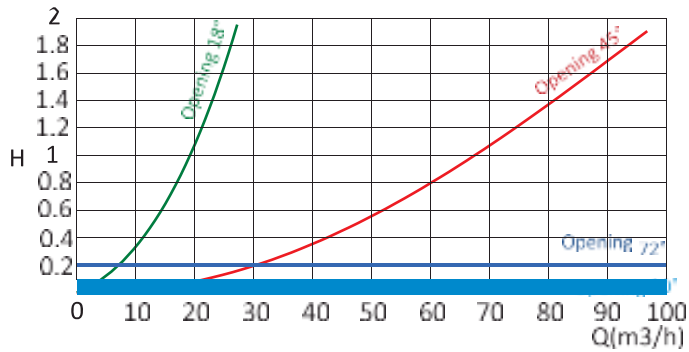

VALVES 125MM

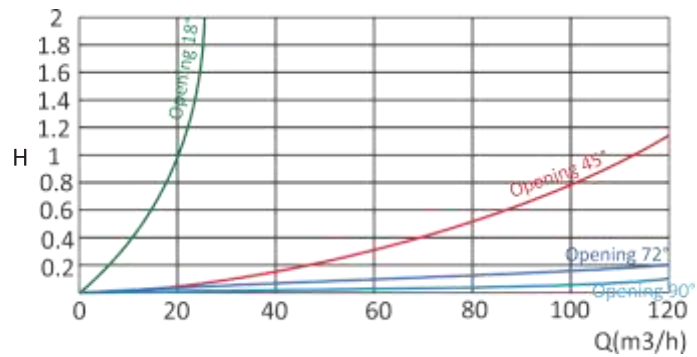

VALVES 140MM

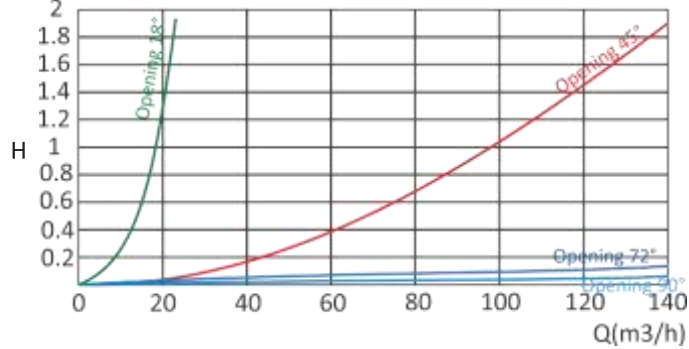

VALVES 160MM

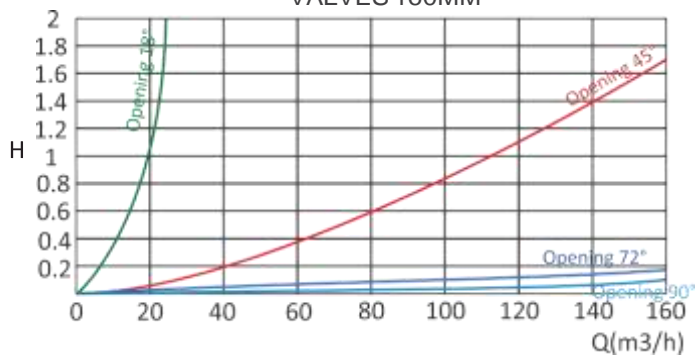

VALVES 200/225MM

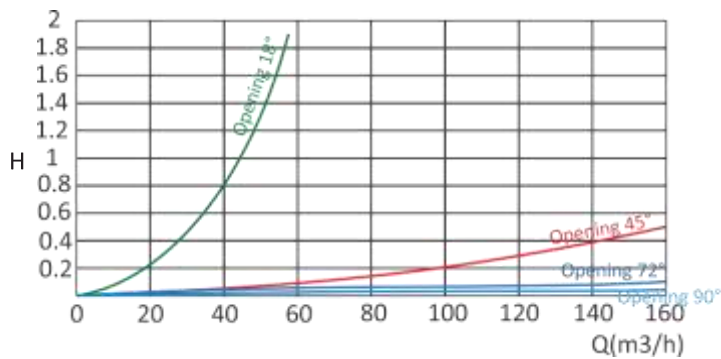

VALVES 250/300 MM

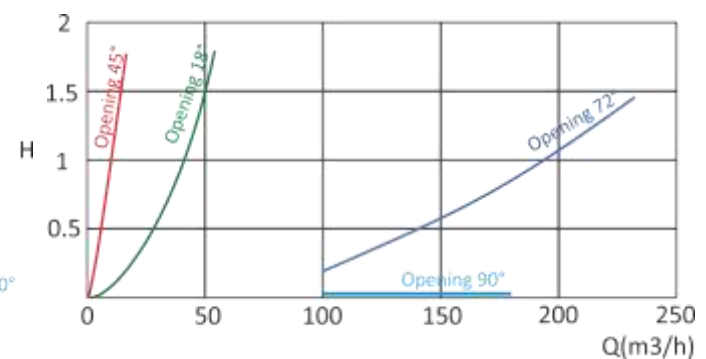

19 QUARTZ SAND

- Quartziferous sand.
- White color.
- Grinded quartz in 25 kg bags.



CODE	GRANULOMETRY	PACKING	WEIGHT	VOLUME
	mm		kg	m ³
FM-01	0.4 - 0.8	1	25	0.015
FM-02	1.0 - 2.0	1	25	0.015
FM-03	2.0 - 3.0	1	25	0.015
FM-04	3.0 - 5.0	1	25	0.015

20 ACTIVATED FILTER MEDIA

BIOLOGICAL INSTEAD OF CHEMICAL APPROACH

Traditional water treatment tries to avoid disease transmission by using more and more chlorine, UVC irradiation or ozone. But the transmission of pathogens is a biological problem; it therefore needs a biological solution. The approach of the Dryden Aqua integrated water treatment system does exactly that: Instead of using more powerful disinfections and expensive equipment, we design a pool water treatment process that changes the water to make it difficult for virus, bacterium and parasites to live and to reproduce:

PREVENT INSTEAD OF KILLING!

1. No substrate: As a consequence of our bio-resistant AFM[®], bacterium have no substrate on which they can grow and multiply.

2. No nutrients: We remove food for bacteria by advanced coagulation, variable Speed Pump flocculation and filtration. Bacterium cannot grow anymore.

3. The lower the chlorine demand, the lower the disinfection by-products (DBP'S): DAISY filters almost everything out of the water and reduces the chlorine demand to the lowest level possible. The lower the chlorine oxidation demand, the lower the concentration of chlorine disinfection by-products in the water and in the air. AFM[®] stands for Activated Filter Media, a revolutionary filter media made from green container glass, developed by marine biologist Dr. Howard Dryden. AFM[®] exceeds the performance of quartz and glass sand by filtering 30% - 50% more organics and sub 5 micron particles out of the water. The catalytic properties on the surface of AFM[®] make it self-sterilizing and bio-resistant, which means no biofilm is formed in the filter bed. This reduces the chlorine demand and therefore the formation of harmful volatile disinfection by products such as THM's, cyanogen chloride and trichloramine. Not only the chlorine smell but also the risk of getting infected by pathogens like Legionella or cryptosporidium, is greatly reduced. The pool is healthier for people, especially children, safer for the environment and economical with crystal clear water. AFM[®] has been successfully used in over 500'000 public and private swimming pools worldwide.

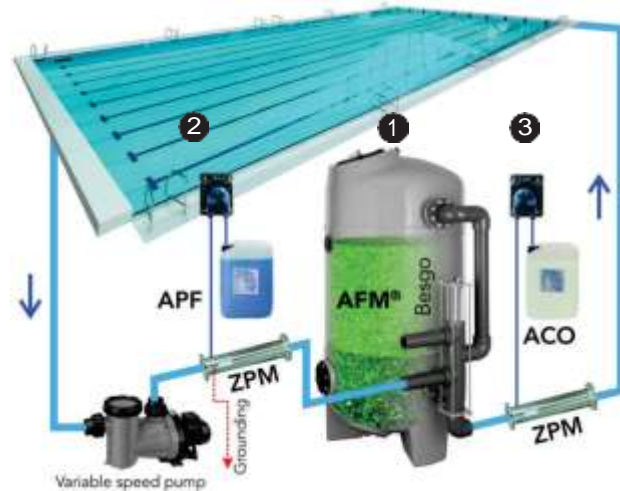

- ① Filtration with AFM[®]
- ② Coagulation and flocculation with APF and ZPM
- ③ Catalytic oxidation with ACO

AFM® — ACTIVATED FILTER MEDIA 10

AFM® is a unique bio resistant filter media. The raw material used for AFM® is green container glass. The glass is washed, disinfected, thermally treated then reduced to a very specific grain size and shape.

For security reasons, the production process (cyclonic size reduction) assures that no dangerous glass splinters are present in the filter media. After size reduction, the grains are activated in a patented three step process. This creates a mesoporous structure with a huge catalytic surface area of 50'000 m² per m³. The surface area is 300 times larger than the surface area of sand or other glass filter media. The surface area is important for all adsorptive and catalytic reactions. In contact with the water free radicals (OH-radicals) are formed, which protect the surface from bio-fouling. The larger the surface area the higher performance and bio—resistance you will get from the media.

To produce one ton of AFM®, 1,8 tons of green glass is needed. AFM is produced according to ISO 9001-2008 standards. We now also have the worlds most important certification for drinking water: NSF 61.

Advantages:

- Crystal clear water
AFM® filters at least 30-50% more than quartz or glass sand.
- Lower consumption of chlorine
The better the filtration, the lower the chlorine demand.
- No trichloramine - no chlorine smell
AFM® prevents growth of biofilm.
- No biofilm — no Legionella
Biofilm is a home for pathogens such as Legionella.
- Perfection for chlorine-free systems
AFM® greatly reduces the oxidation demand.

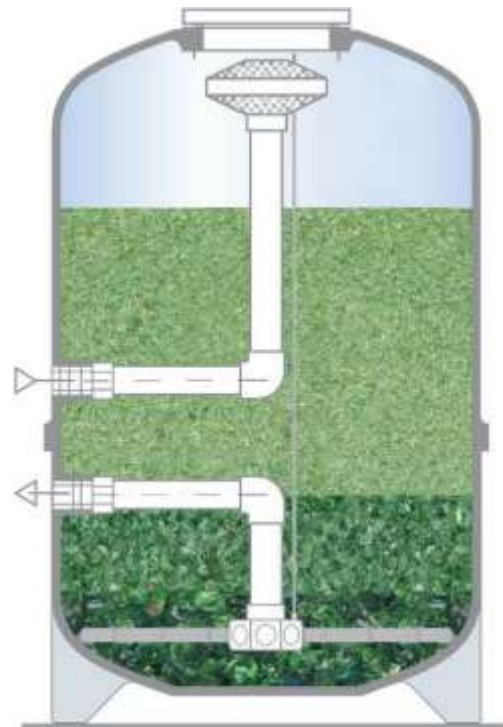

AFM®-ACTIVATED FILTER MEDIA

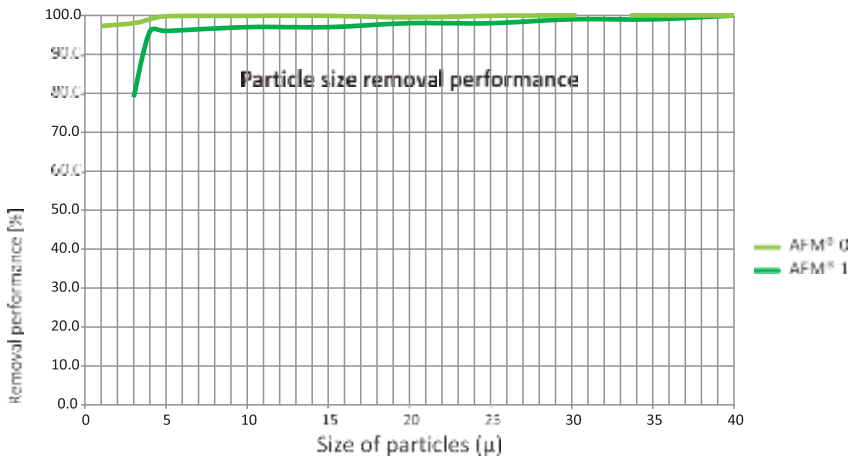

The graph above shows the latest test results (July 2014) from IFTS (Institut de la Filtration et des Techniques Séparatives, www.ifts-sls.com).

Different glass filter media and sand were tested. The experiment was done without flocculation and at a filtration rate of 20 m/h to get a representative comparison. AFM[®] 1 will remove more than 95 % of all particles in the water down to 4 microns. The best a new, very high quality sand or other glass filter media can achieve is 20 microns at an efficiency of 95 %. In addition the filtration performance with AFM[®] will stay at this high level for many years.

AFM[®] 0 has been developed for best filtration where flocculation cannot be used. AFM[®] 0 is able to remove particles of 1 micron at an efficiency of more than 95 %. AFM[®] 0 cannot be combined with flocculation. The backwash speed should be about 30 m/h.

Filter filling:

Dryden Aqua recommends the following layers:

WITHOUT AFM [®] 0	WITH AFM [®] 0
70% AFM [®] 1	20% AFM [®] 0
15% AFM [®] 2 as supporting layer	50% AFM [®] 1
15% AFM [®] 3 as supporting layer	30% AFM [®] 2 and AFM [®] 3 as supporting layer

Remark:

For smaller filters (<1000 mm diameter) and for all filters with nozzle plate irrespective of filter diameter, use 70 % of AFM[®]1 and 30% of AFM[®]2. AFM[®] 3 is for larger diameter filters to ensure adequate filtration.



CODE	DESCRIPTION	PACKING	WEIGHT	VOLUME
			kg	m ³
AFM-00	AFM [®] GRADE 0 0.25 - 0.5 mm	1	25	0.015
AFM-01	AFM [®] GRADE 1 0.5 - 1.0 mm	1	25	0.015
AFM-02	AFM [®] GRADE 2 1.0 - 2.0 mm	1	25	0.015
AFM-03	AFM [®] GRADE 3 2.0 - 4.0 mm	1	25	0.015

21 ZPM-ZETA POTENTIAL MIXER 30



The static mixer for the cavitation of water

ZPM stands for Zeta Potential Mixer and is a static mixer manufactured in stainless steel 1.4571. The cavitation reactions help to disinfect the water for a lifetime.

Upstream of the filter — optimize coagulation and flocculation:

The ZPM amplifies the coagulation and flocculation reactions for the conversion and precipitation of dissolved components into small particles. The cavitation reactions provide the perfect mixing and turbulent environment necessary for coagulation using APF and NoPhos. The ZPM neutralises the electrical charge (Zeta Potential) on dissolved chemicals and small particles to make some positively and some negatively charged. The opposite charges attract and this causes coagulation and flocculation. As the electrical potential drops to neutral, the redox oxidation potential of the water increases by up to 100 mV, effectively the water is beginning to disinfect itself without the use of any chemicals.

Choose the size of the ZPM according to the pressure loss. Pressure loss should be between 1 and 2 mWS (0,1 — 0,2 bar).

Downstream of the filter - mechanical disinfection:

The cavitation produce nano-bubbles that disinfect the water. The higher the pressure loss, the better the disinfection performance. Some pathogens (e.g. Cryptosporidium) as well as biofilm roctected colonies of bacterium floc are extremely resistant to chlorine. The ZPM breaks these colonies or floc apart and allows chlorine to disinfect the water before it reaches the pool.

Choose the size of the ZPM according to the pressure loss. Pressure loss should be between 1 and 5 mWS (0,1 - 0,5 bar)



Imploding nano-bubbles disinfecting water

CODE	SIZE	NO. OF FINNS	CONN.	LENGTH mm	PRESSURE LOSS (M ³ /H)			PACKING	WEIGHT	VOLUME
					2mWS 0.2bar	3mWS 0.3bar	5mWS 0.5bar		kg	m ³
30000	DN 40	3	1" ET	235	5	6.5	8.5	1	0.75	0.0009
30001	DN 40	2	1½" ET	195	10	12	15	1	0.75	0.0008
30002	DN 50	3	2" ET	300	8.5	13	21.5	1	1.2	0.0014
30003	DN 50	2	2" ET	240	15	23	30	1	1.2	0.0012
30004	DN 65	3	2½" ET	332	20	27	40	1	2.8	0.0023
30005	DN 80	3	3" FL	419.6	20	30	45	1	11.2	0.0036
30006	DN 100	3	4" FL	519.6	50	60	80	1	14.4	0.0079
30013	DN 125	3	5" FL	640	70	85	115	1	21	0.0259
30007	DN 150	3	6" FL	759.6	100	125	170	1	26.8	0.0148
30008	DN 200	3	8" FL	979.6	175	220	290	1	41.2	0.0576
30009	DN 250	3	10" FL	1219.6	260	325	420	1	58.6	0.0956